

- RACE GENERAL NOTES:**
(INDEMNIFICATION CLAUSE) THE CONTRACTOR AGREES AND SHALL ASSUME SOLE AND COMPLETE RESPONSIBILITY:
- OF THE JOB SITE CONDITIONS DURING THE COURSE OF CONSTRUCTION OF THIS PROJECT, INCLUDING THE SAFETY OF ALL PERSONS AND PROPERTIES; THAT THESE REQUIREMENTS SHALL APPLY CONTINUOUSLY AND NOT BE LIMITED TO NORMAL WORKING HOURS AND CONDITIONS. THE CONTRACTOR FURTHER AGREES TO DEFEND THIS INDEMNITY AND HOLD RACE COMMUNICATIONS, ITS REPRESENTATIVES, AND ENGINEERS HARMLESS FROM ANY AND ALL LIABILITY, REAL OR ALLEGED IN CONNECTION WITH THE PERFORMANCE OF THE WORK ON THIS PROJECT.
 - PRIOR TO THE BEGINNING OF ANY CONSTRUCTION AND THROUGHOUT THE COURSE OF CONSTRUCTION WORK, THE CONTRACTOR SHALL FULLY COMPLY WITH "CALIFORNIA OCCUPATIONAL SAFETY AND HEALTH" ACT OF 1973 INCLUDING ALL REVISIONS AND AMENDMENTS THEREIN.
 - ALL WORK SHALL CONFORM TO THE LATEST EDITION OF GO 95, 128, AND THE STANDARD "SPECIFICATIONS FOR PUBLIC WORKS CONSTRUCTION", AS ADOPTED BY THE CITY, COUNTY, OR STATE AS MODIFIED BY STANDARD PLANS AND ADDENDUMS.
 - THE EXISTENCE AND LOCATION OF UTILITIES AND OTHER AGENCIES' FACILITIES AS SHOWN HEREON ARE OBTAINED BY A SEARCH OF AVAILABLE RECORDS. OTHER FACILITIES MAY EXIST. THE CONTRACTOR SHALL VERIFY PRIOR TO THE START OF CONSTRUCTION AND SHALL USE EXTREME CARE AND PROTECTIVE MEASURES TO PREVENT DAMAGE TO THESE FACILITIES. THE CONTRACTOR IS RESPONSIBLE FOR THE PROTECTION OF ALL UTILITY AND AGENCY FACILITIES WITHIN THE LIMITS OF WORK, WHETHER THEY ARE SHOWN ON THIS PLAN OR NOT.
 - THE CONTRACTOR SHALL NOTIFY UNDERGROUND SERVICE ALERT (800) 227-2600 AT LEAST THREE WORKING DAYS PRIOR TO THE START OF ANY EXCAVATION.
 - THE CONTRACTOR SHALL NOTIFY THE CITY, COUNTY OR STATE ENGINEER INSPECTION DEPARTMENT AT LEAST TWO DAYS PRIOR TO THE START OF ANY WORK REQUIRING THEIR INVOLVEMENT.
 - ALL WORK AREA AND STREET TRAFFIC CONTROL SHALL BE IN ACCORDANCE WITH THE SPECIFICATIONS OF THE MANUAL ON UNIFORM TRAFFIC CONTROL DEVICES (M.U.T.C.D.) AND SPECIFICATIONS FROM THE CITY, COUNTY, OR STATE.
 - THE CITY, COUNTY, OR STATE SHALL SPECIFY THE EXPIRATION PERIOD OF THE PERMIT FOR THIS CONSTRUCTION PROJECT.
 - THE MINIMUM COVER FOR ALL CONDUITS PLACED UNDERGROUND SHALL BE 42 INCHES TO THE FINISHED GRADE AT ALL TIMES.
 - THE CONTRACTOR SHALL TUNNEL UNDER ALL CURB AND GUTTERS AND BORE ALL UNDER CONCRETE DRIVEWAYS AND ASSIST RAMPS AT THE DIRECTION OF THE CITY, COUNTY, OR STATE ENGINEERS.
 - ALL A/C AND/OR CONCRETE PAVEMENT SHALL BE REPLACED AT THE DIRECTION OF THE CITY, COUNTY, OR STATE ENGINEERS.
 - ALL SHRUBS, PLANTS, OR TREES THAT HAVE BEEN DAMAGED OR DISTURBED DURING THE COURSE OF THE WORK, SHALL BE REPLANTED AND/OR REPLACED SO AS TO RESTORE THE WORK SITE TO ITS ORIGINAL CONDITION.
 - IF DAMAGE OCCURS TO CITY OR COUNTY FACILITIES, THE CONTRACTOR SHALL IMMEDIATELY NOTIFY THE CITY, COUNTY OR STATE ENGINEER'S OFFICE.
 - AT LEAST TWO DAYS PRIOR TO THE COMMENCEMENT OF ANY WORK, NOTIFY THE POLICE TRAFFIC BUREAU AND THE FIRE DEPARTMENT.
 - THE CONTRACTOR WILL BE RESPONSIBLE FOR THE PROCESSING OF ALL APPLICATION PERMIT FORMS ALONG WITH THE REQUIRED LIABILITY INSURANCE FORMS, CLEARLY DEMONSTRATING THAT RACE COMMUNICATIONS, THE CITY, COUNTY, OR STATE ARE ALSO INSURED WITH THE REQUIRED LIABILITY INSURANCE IN THE AMOUNT OF \$1,000,000.00 FOR THIS CONSTRUCTION PROJECT.
 - VAULTS, PEDESTALS, CONDUITS AND OTHER TYPES OF SUBSTRUCTURE ARE EITHER SPECIFIED ON THIS PLAN OR WILL BE SPECIFIED BY THE CONSTRUCTION ENGINEER. ANY AND ALL DEVIATIONS FROM THE SPECIFIED TYPES OF MATERIAL MUST BE APPROVED BY THE SYSTEM ENGINEER, IN WRITING, BEFORE INSTALLATION THEREOF.
 - ALL UNDERGROUND CONDUIT MUST BE SCHEDULE 40 OR BETTER, UNLESS SPECIFIED.

- CALTRANS GENERAL NOTES:**
- ALL WORK WITHIN THE STATE HIGHWAY RIGHT-OF-WAY INCLUDING TEMPORARY TRAFFIC CONTROLS SHALL CONFORM TO THE CURRENT CALTRANS STANDARD PLANS AND SPECIFICATIONS.
 - ALL TRAFFIC CONTROL WORK FOR CONSTRUCTION SHALL CONFORM TO THE 2014 CALIFORNIA MUTCD.
 - ALL SIGNING AND STRIPING SHALL CONFORM TO THE CALIFORNIA MUTCD, STANDARD PLANS AND SPECIFICATION.
 - ALL SIGNS SHALL BE RETRO-REFLECTIVE.
 - CONTRACTOR SHALL HAVE ALL SIGNS, DELINEATORS, BARRICADES, ETC., PROPERLY INSTALLED PRIOR TO COMMENCING CONSTRUCTION.
 - NO EQUIPMENT OR MATERIALS SHALL BE STORED ON THE ROAD SURFACE DURING NON-WORKING PERIODS UNLESS IT IS ALLOWED BY A CALTRANS ENGINEER IN WRITING.
 - NO EQUIPMENT OR MATERIALS SHALL BE STORED ON THE SIDEWALK AT ANY TIME.
 - EXCAVATION MATERIALS SHALL BE STORED AWAY FROM PAVED ROADWAY WHENEVER POSSIBLE. ALL SPILLED MATERIAL IS TO BE REMOVED TO AVOID SLIPPERY CONDITIONS.
 - EXISTING SIGNS, DELINEATORS, GUARDRAILS, MARKERS, TREES, SHRUBS, FENCES, WALKS, STEPS, ETC. THAT ARE DISTURBED BY THIS CONSTRUCTION SHALL BE PLACED OR RESTORED TO THEIR ORIGINAL CONDITION OR TO THE SATISFACTION OF THE ADJACENT PROPERTY OWNERS AND THE CALTRANS ENGINEER.
 - PERMITTEE SHALL SECURE AN ENCROACHMENT PERMIT FROM CALTRANS PRIOR TO COMMENCEMENT OF WORK. ALL WORK WITHIN THE PUBLIC RIGHT OF WAY SHALL BE DONE UNDER AN ENCROACHMENT OPENING PERMIT.
 - IT IS THE CONTRACTOR'S RESPONSIBILITY TO REPLACE ALL STREET MONUMENTS, LOT CORNER PIPES, AND GRADE STAKES DISTURBED DURING THE PROCESS OF CONSTRUCTION REGARDLESS OF COST.
 - CONTRACTORS SHALL PROVIDE ADEQUATE DUST CONTROL AND KEEP MUD AND DEBRIS OFF THE PUBLIC RIGHT OF WAY AT ALL TIMES.
 - ALL SIDEWALK, CURB AND GUTTER SHALL BE REMOVED AND REPLACED TO THE NEAREST SCORE MARK OR AS DIRECTED BY THE CALTRANS ENGINEER. INSTALLATION OF NEW SIDEWALK, CURB AND GUTTER AGAINST EXISTING IMPROVEMENTS MAY REQUIRE A SIDEWALK CONTACT JOINT (DOWELS REQUIRED) IF DIRECTED BY CALTRANS ENGINEER.
 - ALL TRENCHES AND EXCAVATIONS SHALL BE CONSTRUCTED IN STRICT COMPLIANCE WITH THE APPLICABLE SECTIONS OF CALIFORNIA AND FEDERAL O.S.H.A. REQUIREMENTS AND OTHER APPLICABLE SAFETY ORDINANCES. CONTRACTOR SHALL BEAR FULL RESPONSIBILITY FOR TRENCH SHORING DESIGN AND INSTALLATION.
 - WHEN TRENCH EXCAVATION ACTIVITY HAS BEEN COMPLETED OR PUT ON HOLD, THE TRENCH MUST BE BACKFILLED OR PROTECTED AS SPECIFIED IN THE STANDARD SPECIFICATIONS 2012, SECTION 86-2.01.

DISTRICT	COUNTY	ROUTE	POSTMILE - TOTAL PROJECT
08	SB	15	30.13 - 30.45

H1032 Plow			
Dimensions	U.S.	Metric	
A Cover depth*	36 in	975 mm	
A' PENETRATION*	40 in	1.02 m	
A3' ANGLE OF DEPARTURE, TRANSPORT, NO BLADE	47.5°	47.5°	
A3 ANGLE OF DEPARTURE, TRANSPORT, 24" (610-mm) BLADE	30°	30°	
ANGLE OF DEPARTURE, TRANSPORT, 30" (760-mm) BLADE	24°	24°	
H ANGLE OF DEPRESSION, PLOW MAX.	25°	25°	
H2 HEIGHT TRANSPORT	93 in	2.36 m	
J BLADE FROUNG CLEARANCE, 30" (760-mm) BLADE	24 in	610 mm	
L2 ATTACHMENT LENGTH, FULLY LOWERED, NO BLADE	97 in	2.46 mm	
L2' ATTACHEMENT LENGTH, FULLY RAISED, NO BLADE	78 in	1.98m	
PLOW SWING ANGLE	43°	43°	
INCLUSIVE BLADE STEER ANGLE	89°	89°	
CENTER OF PLOW TO OUTSIDE EDGE OF MACHINE, LEFT	43.5 in	1.11 m	
CENTER OF PLOW TO OUTSIDE EDGE OF MACHINE, RIGHT	45.5 in	1.11 m	
OPERATION			
PLOW VIBRATOR FORCE @ 1800 RPM	35,215 lb	157 kN	
MAXIMUM MATERIAL DIAMETER			
PULLED	3 in	80 mm	
FED	2 in	50 mm	
GENERAL			
ATTACHMENT WEIGHT, WITHOUT PLOW BLADE	2600 lb	1180kg	
COUNTERWEIGHT REQUIRED. CONTACT YOUR LOCAL DITCH WITCH® DEALER FOR COUNTERWEIGHT REQUIREMENTS.			

CONSTRUCTION TOTALS

ASPHALT CUT:	--	SF
CONCRETE CUT:	--	SF
DIRT CUT:	564	SF
BORE:	208	F
EXISTING CONDUIT	440	F
SIDEWALK REPLACEMENT	45	SF
BORE PITS (DIRT):	60	SF
BORE PITS (PAVEMENT):	--	SF
TOTAL:	1,212	F

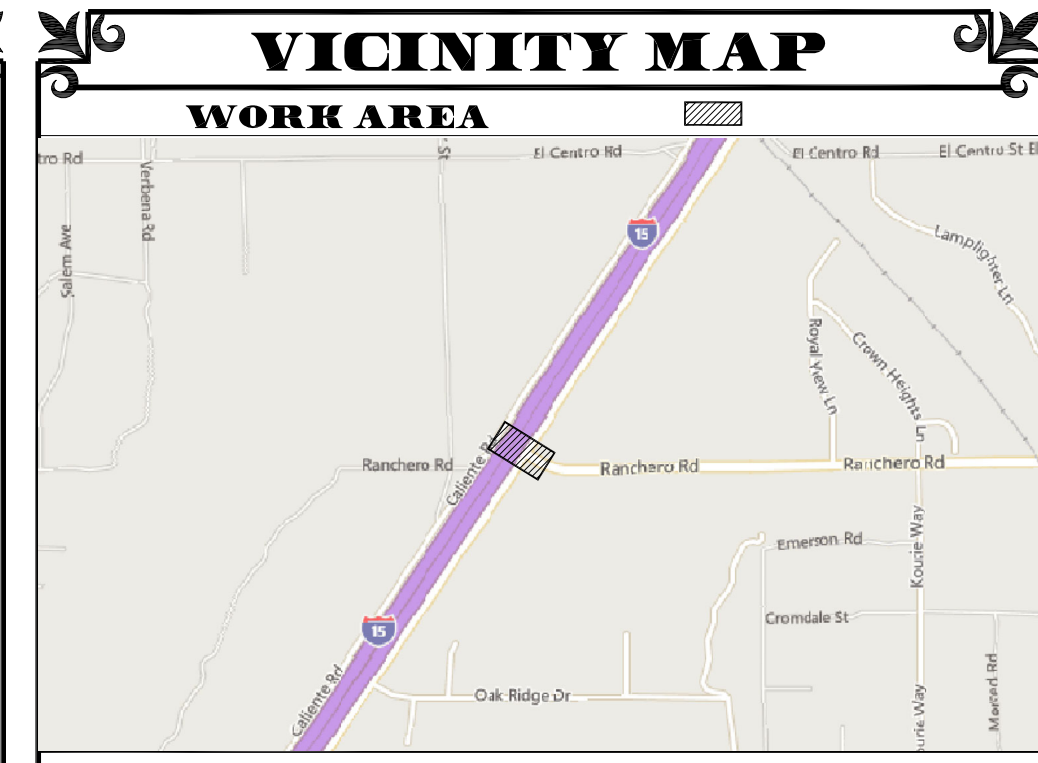

PREPARED BY:
O-S-Pro
 Telecom Solutions, LLC
 2001 THIRD ST #H, RIVERSIDE, CA 92507
 (626) 320-0996 | peterm@ospro.net

LEGEND
PROPOSED WORK

SYMBOL/LINETYPE	DESCRIPTION
	CONCRETE RESTORATION
	ASPHALT RESTORATION
	PROPOSED CONDUIT

EXISTING STRUCTURES

SYMBOL/LINETYPE	ABV.	DESCRIPTION
	POLE	UTILITY POLE
	MH	MANHOLE
	HH	HAND HOLE
	PED	PEDESTAL
	F/H	FIRE HYDRANT
	VLV	VALVE
	TS	TRAFFIC SIGNAL
	SL	STREET LIGHT
	VNT	VENT
	MTR	WATER METER
	TR	BOLLARD
		TREE

EXISTING UTILITIES

SYMBOL/LINETYPE	DESCRIPTION
	STREET LIGHT CONDUIT
	ELECTRIC
	TELEPHONE
	GAS
	STORM DRAIN
	SANITARY SEWER
	WATER
	CATV
	TRAFFIC CONDUIT
	COMM

MISC. LINETYPES

SYMBOL/LINETYPE	ABV.	DESCRIPTION
	C/L	CENTER LINE
	R/W	RIGHT OF WAY
	P/L	PROPERTY LINE
	EOP	EDGE OF PAVEMENT
	FOC	FRONT OF CURB
	C&G	CURB & GUTTER
	R/R	RAILROAD

MISC. ABBREVIATIONS

ABRV.	DESCRIPTION
BCF	BEHIND CURB FACE
FCF	FRONT OF CURB FACE
CONC.	CONCRETE
EX	EXISTING
U/G	UNDERGROUND
S/W	SIDEWALK
D/W	DRIVEWAY
PL	PLACE (INSTALL NEW)

NOTICE TO CONTRACTORS
 THE EXISTENCE AND LOCATION OF ALL UNDERGROUND UTILITIES SHOWN HERE WERE OBTAINED BY A SEARCH OF AVAILABLE RECORDS. CONTRACTOR IS REQUIRED TO LOCATE AND POT-HOLE ALL EXISTING UTILITY CROSSINGS PRIOR TO CONSTRUCTION.

DIGALERT
 CALL TOLL FREE
 48 HOURS BEFORE YOU DIG
 UNDERGROUND SERVICE ALERT
 PHONE NO. 811

CONSTRUCTION PLAN

CLIENT LOGO	DRAWN	CB
	DESIGN	CB
	CHECKED	OSPRO
	DATE	2018
15 FWY CROSSING 15 FWY AND RANCHERO RD. HESPERIA, CA. 92345		1 of 4

PROJECT #	TRACKING #.	REV
		0

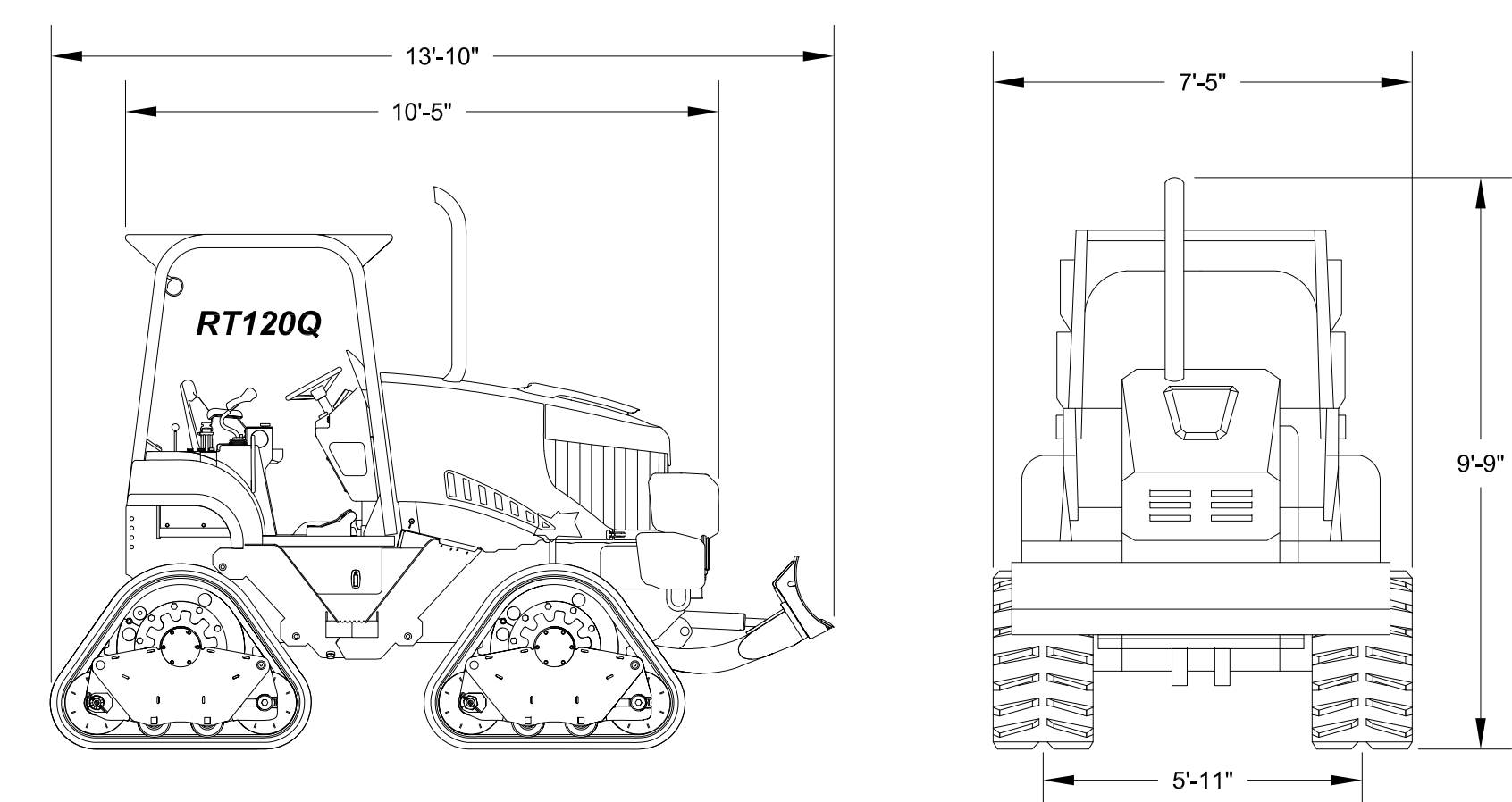
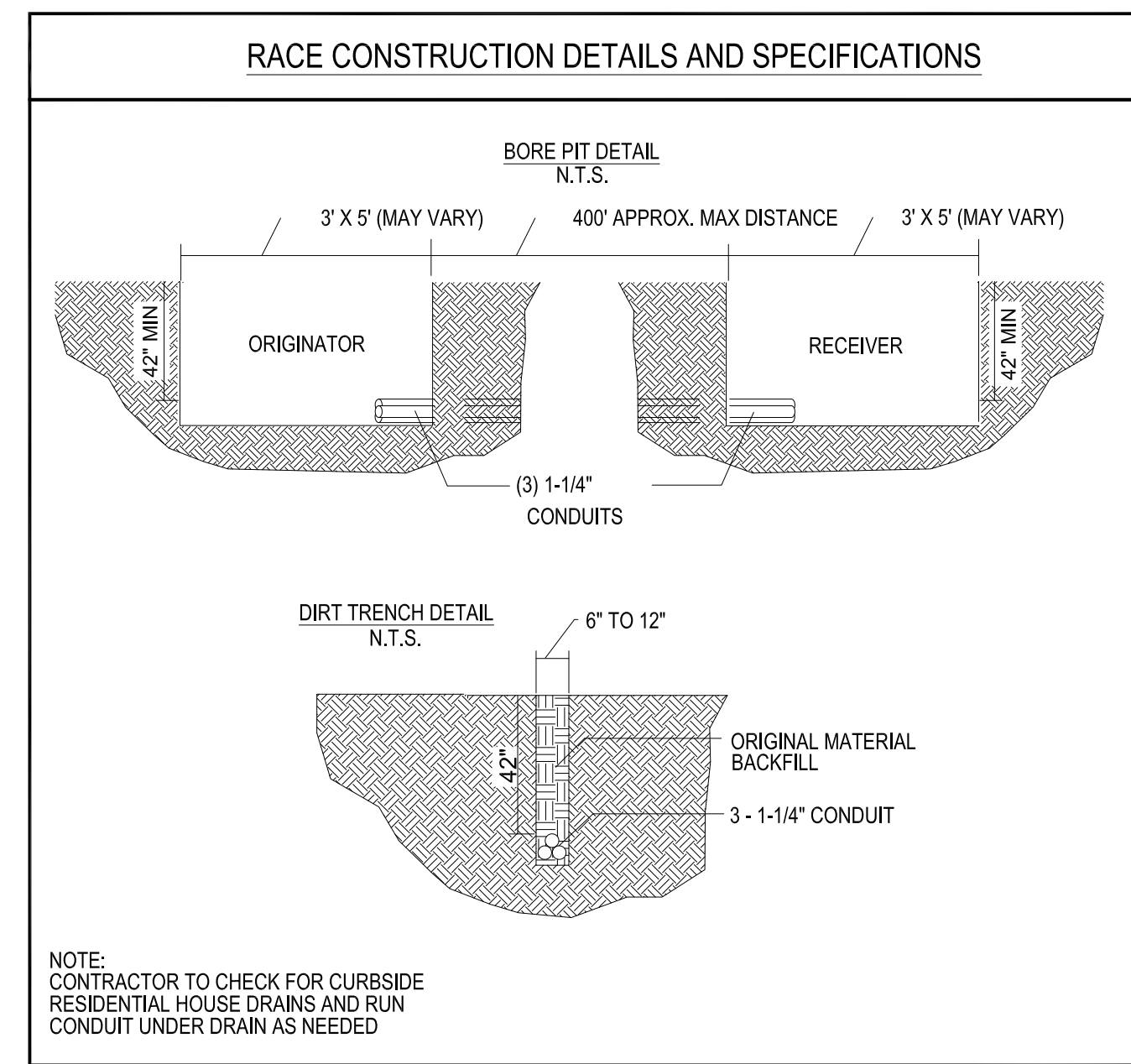
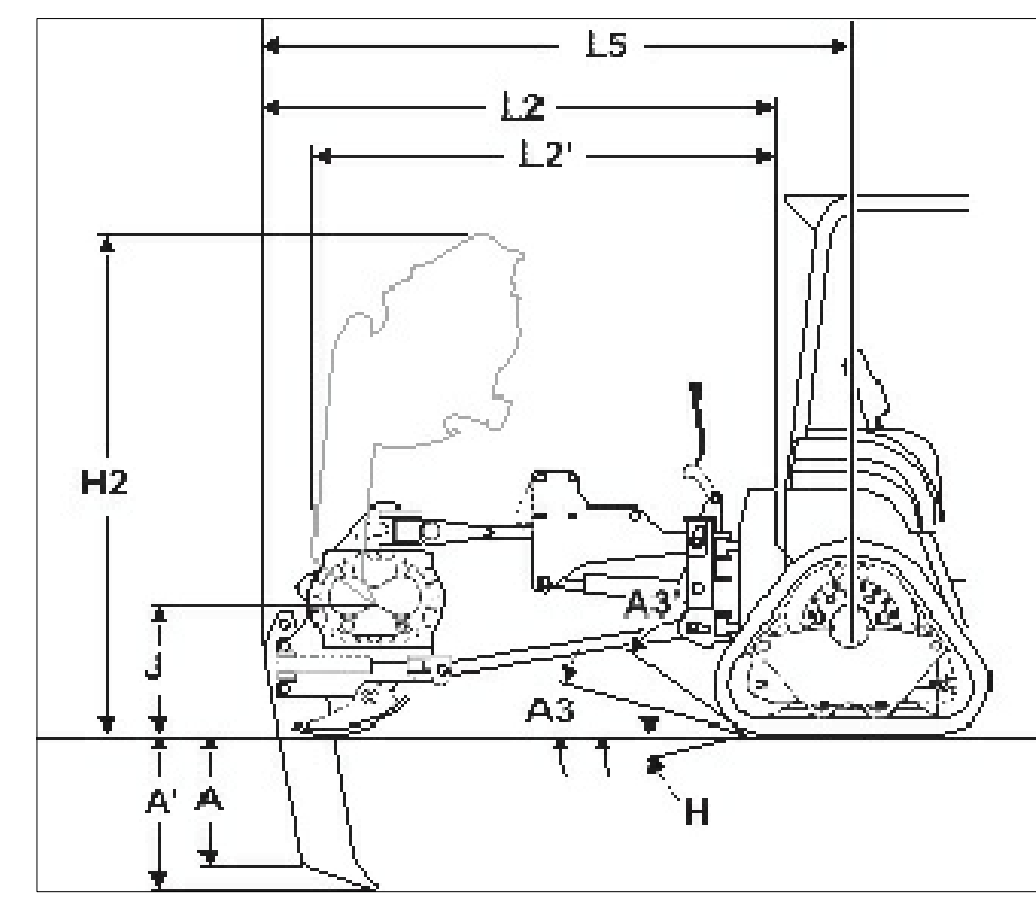
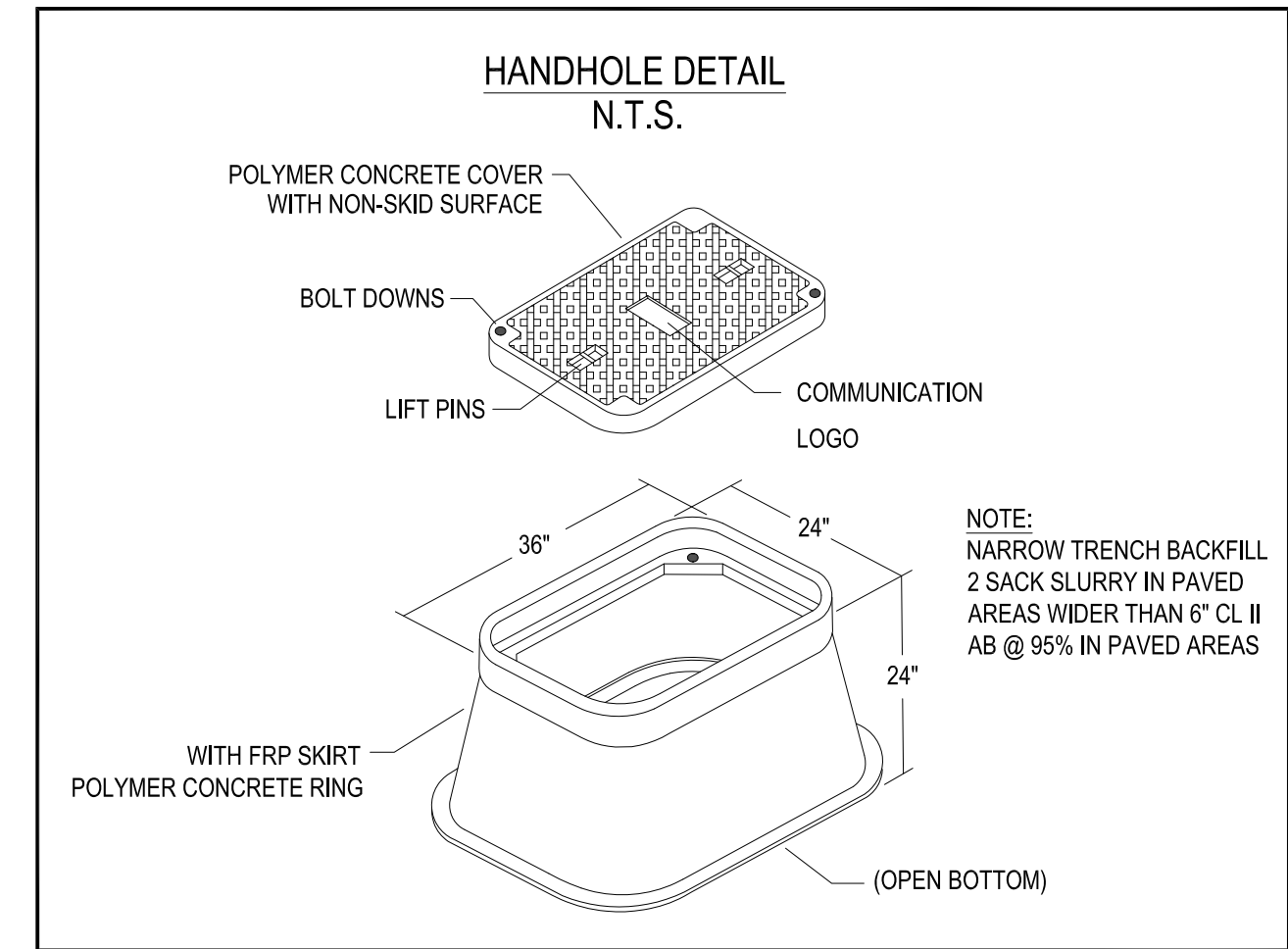
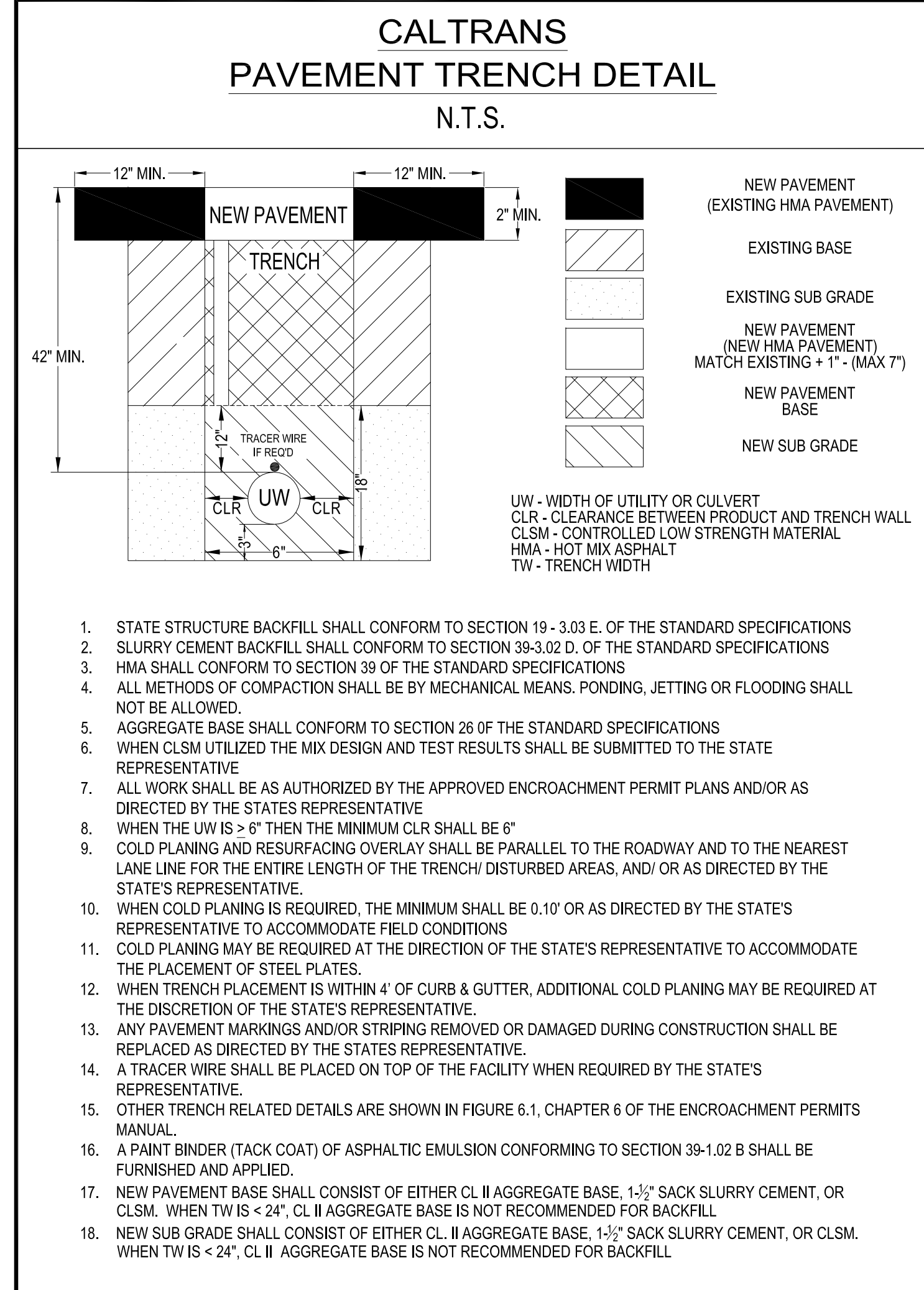

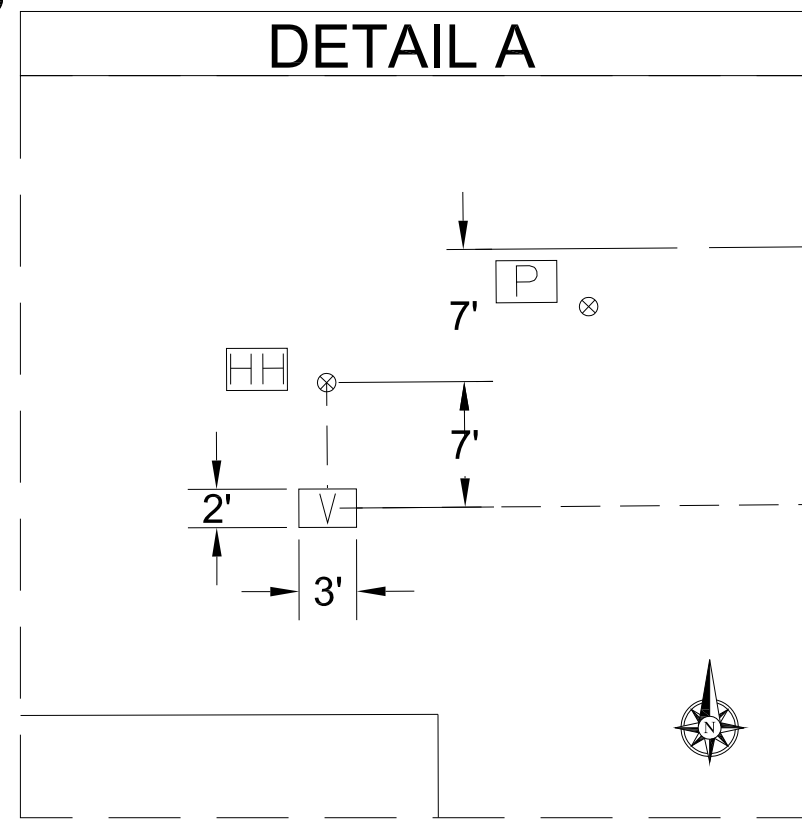

CALIENTE RD
EX. POLE# 4771745E

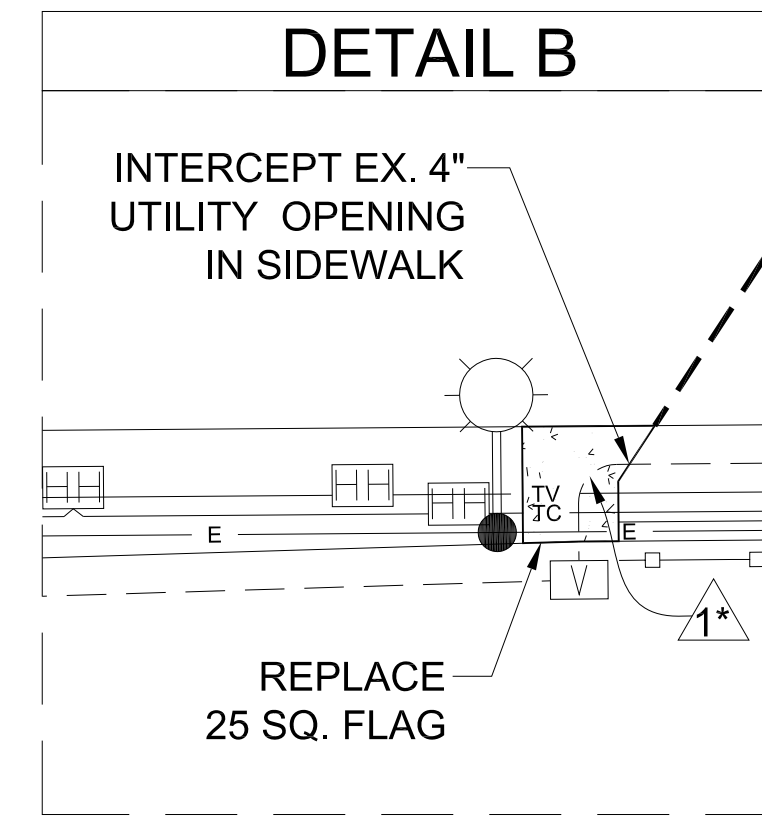
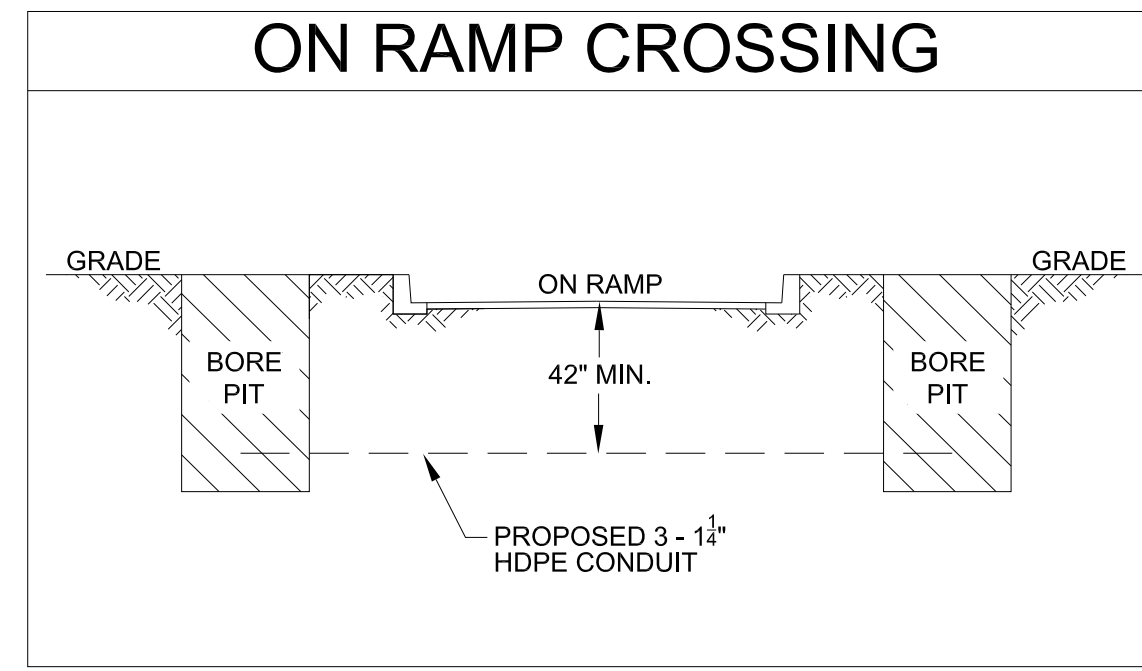
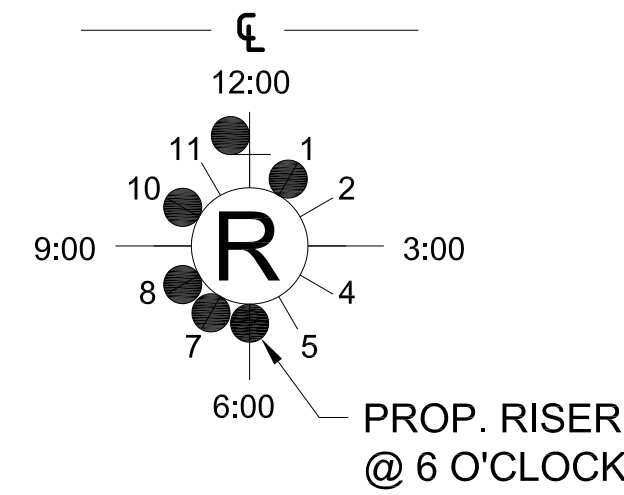

PROPOSED VAULT LOCATION		
VAULT #	VAULT SIZE	LOCATION
1	2' X 3' VAULT	13' S OF RANCHERO RD C/L @ STA 8+80
2	2' X 3' VAULT	79' E OF CALIENTE RD C/L @ STA 11+10
3	2' X 3' VAULT	80' S OF RANCHERO RD C/L @ STA 14+57
4	2' X 3' VAULT	72' S OF RANCHERO RD C/L @ STA 17+65

PROPOSED ITEM #	DESCRIPTION
1	7' VAULT 1 TO EX. POLE# 4771745E 3 - 1 1/4" HDPE CONDUIT
2	149' VAULT 1 TO BORE PIT 3 - 1 1/4" HDPE CONDUIT
3	146' BORE PIT TO BORE PIT 3 - 1 1/4" HDPE CONDUIT
4	402' VAULT 2 TO VAULT 3 3 - 1 1/4" HDPE CONDUIT
5	12' VAULT 3 TO BOUNDARY LINE 3 - 1 1/4" HDPE CONDUIT
6	127' BOUNDARY LINE TO BORE PIT 3 - 1 1/4" HDPE CONDUIT
7	71' BORE PIT TO BORE PIT 3 - 1 1/4" HDPE CONDUIT
8	188' BORE PIT TO VAULT 4 3 - 1 1/4" HDPE CONDUIT
9	7' VAULT 4 TO EX. UTILITY OPENING 3 - 1 1/4" HDPE CONDUIT
10	440' THROUGH EX. 4" UTILITY OPENING 3 - 1 1/4" HDPE CONDUIT

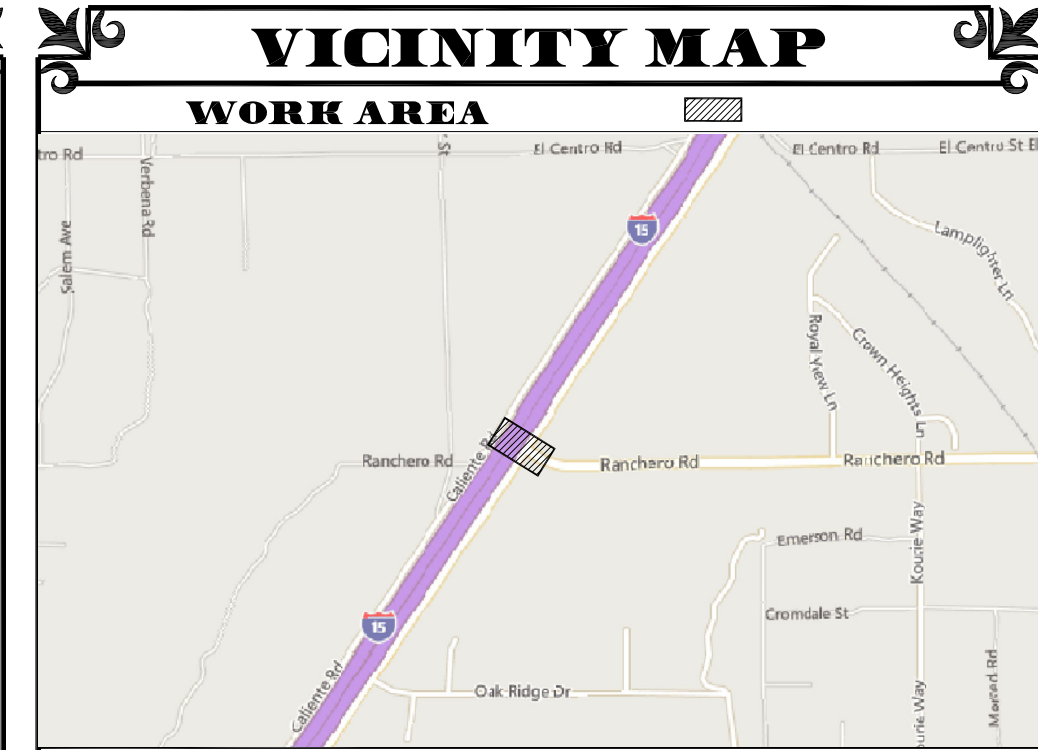

PREPARED BY:
O-S-Pro
Telecom Solutions, LLC
2001 THIRD ST #H, RIVERSIDE, CA 92507
(626) 320-0996 | peterm@ospro.net

LEGEND

PROPOSED WORK

SYMBOL/LINETYPE	DESCRIPTION
[Symbol]	CONCRETE RESTORATION
[Symbol]	ASPHALT RESTORATION
[Symbol]	PROPOSED CONDUIT

EXISTING STRUCTURES

SYMBOL/LINETYPE	ABV.	DESCRIPTION
[Symbol]	POLE	UTILITY POLE
[Symbol]	MH	MANHOLE
[Symbol]	HH	HAND HOLE
[Symbol]	PED	PEDESTAL
[Symbol]	F/H	FIRE HYDRANT
[Symbol]	VLV	VALVE
[Symbol]	TS	TRAFFIC SIGNAL
[Symbol]	SL	STREET LIGHT
[Symbol]	VNT	VENT
[Symbol]	MTR	WATER METER
[Symbol]	BOLL	BOLLARD
[Symbol]	TR	TREE

EXISTING UTILITIES

SYMBOL/LINETYPE	DESCRIPTION
[Symbol]	STREET LIGHT CONDUIT
[Symbol]	ELECTRIC
[Symbol]	TELEPHONE
[Symbol]	GAS
[Symbol]	STORM DRAIN
[Symbol]	SANITARY SEWER
[Symbol]	WATER
[Symbol]	CATV
[Symbol]	TRAFFIC CONDUIT
[Symbol]	COMM

MISC. LINETYPES

SYMBOL/LINETYPE	ABV.	DESCRIPTION
[Symbol]	C/L	CENTER LINE
[Symbol]	R/W	RIGHT OF WAY
[Symbol]	P/L	PROPERTY LINE
[Symbol]	EOP	EDGE OF PAVEMENT
[Symbol]	FOC	FRONT OF CURB
[Symbol]	C&G	CURB & GUTTER
[Symbol]	R/R	RAILROAD

MISC. ABBREVIATIONS

ABBV.	DESCRIPTION
BCF	BEHIND CURB FACE
FCF	FRONT OF CURB FACE
CONC.	CONCRETE
EX	EXISTING
U/G	UNDERGROUND
S/W	SIDEWALK
D/W	DRIVEWAY
PL	PLACE (INSTALL NEW)

NOTICE TO CONTRACTORS

THE EXISTENCE AND LOCATION OF ALL UNDERGROUND UTILITIES SHOWN HERE WERE OBTAINED BY A SEARCH OF AVAILABLE RECORDS. CONTRACTOR IS REQUIRED TO LOCATE AND POT HOLE ALL EXISTING UTILITY CROSSINGS PRIOR TO CONSTRUCTION.



CONSTRUCTION PLAN

CLIENT LOGO	DRAWN	CB
	DESIGN	CB
	CHECKED	OSPRO
	DATE	2018
15 FWY CROSSING 15 FWY AND RANCHERO RD. HESPERIA, CA. 92345		2 OF 4
PROJECT #	TRACKING #	REV 0

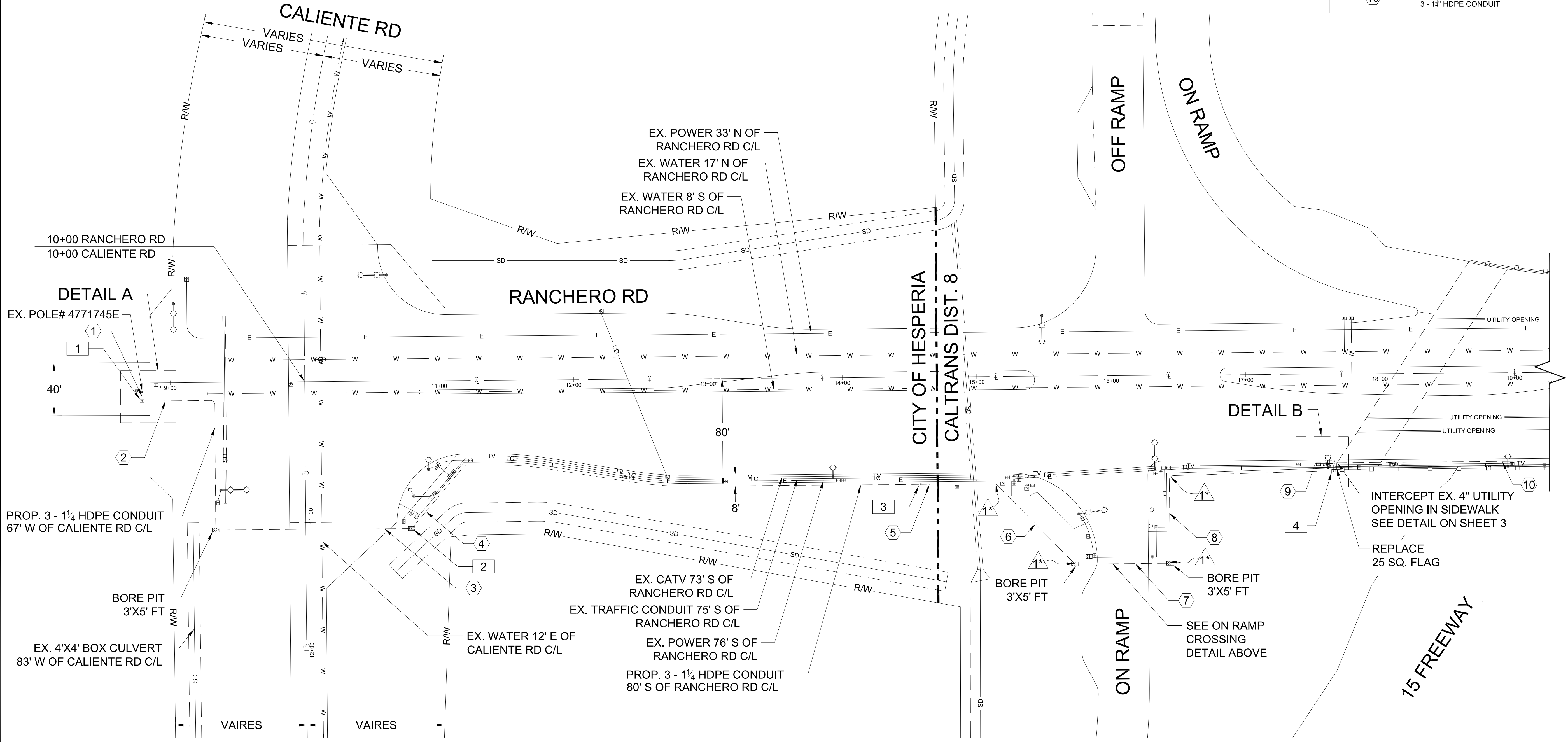

SEE SHEET 3



PROPOSED ITEM #	DESCRIPTION
11	6' VAULT 5 TO EX. 4" UTILITY OPENING 3 - 1 1/2" HDPE CONDUIT
12	155' VAULT 5 TO BORE PIT 3 - 1 1/2" HDPE CONDUIT
13	137' BORE PIT TO BORE PIT 3 - 1 1/2" HDPE CONDUIT
14	81' BORE PIT TO BOUNDARY LINE 3 - 1 1/2" HDPE CONDUIT
15	101' BOUNDARY LINE TO VAULT 6 3 - 1 1/2" HDPE CONDUIT
16	500' VAULT 6 TO VAULT 7 3 - 1 1/2" HDPE CONDUIT

PROPOSED VAULT LOCATION		
VAULT #	VAULT SIZE	LOCATION
5	2' X 3' VAULT	72' S OF RANCHERO RD C/L @ STA 22+07
6	2' X 3' VAULT	72' S OF RANCHERO RD C/L @ STA 26+84

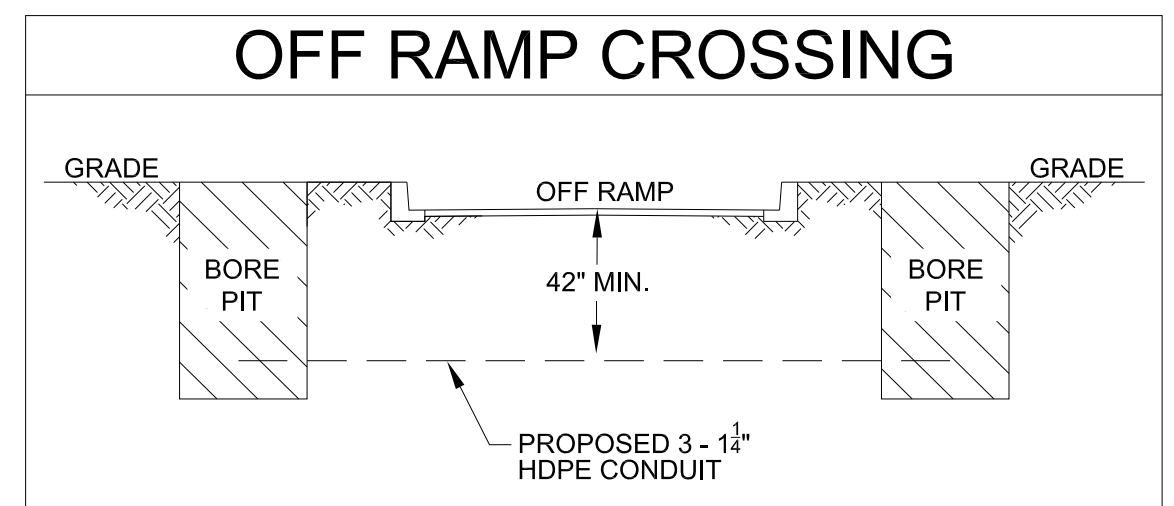
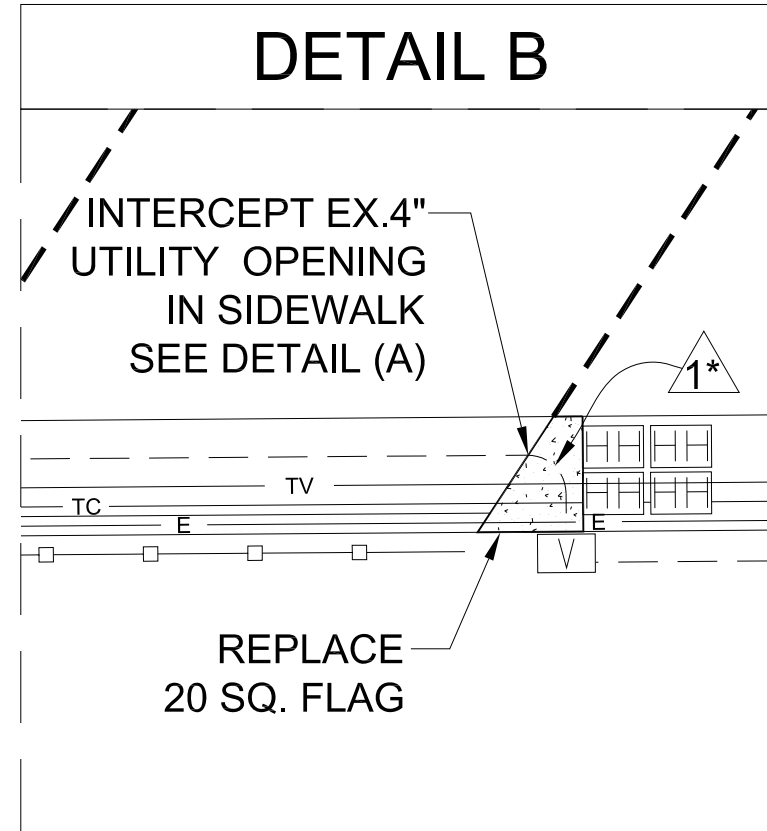
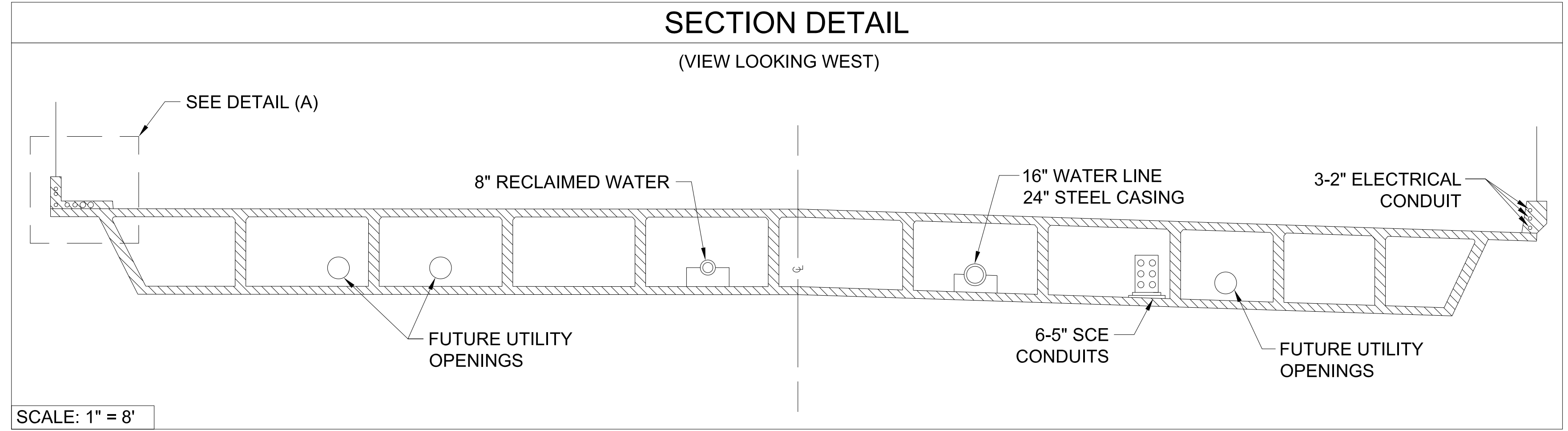
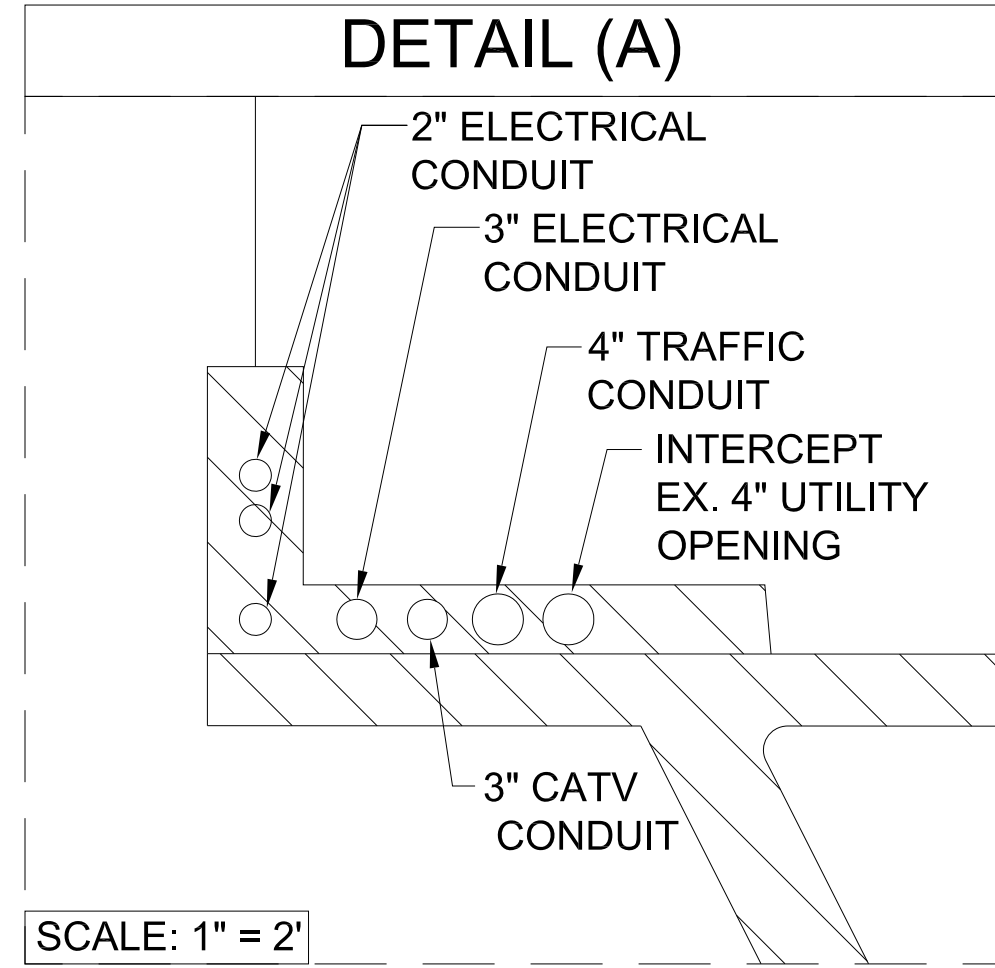

CONDUIT BEND
RADIUS 24" - 36"

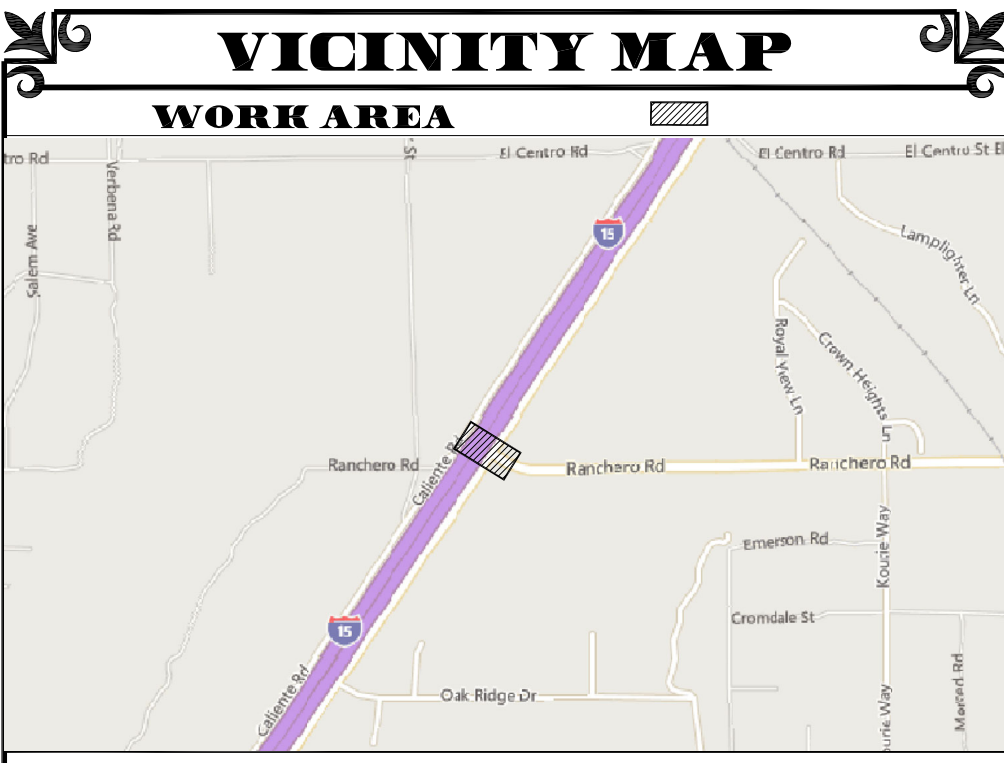

PREPARED BY:
O-S-Pro
Telecom Solutions, LLC
2001 THIRD ST #H, RIVERSIDE, CA 92507
(626) 320-0996 | peterm@ospros.net

LEGEND

PROPOSED WORK

SYMBOL/LINETYPE	DESCRIPTION
[Symbol]	CONCRETE RESTORATION
[Symbol]	ASPHALT RESTORATION
[Symbol]	PROPOSED CONDUIT

EXISTING STRUCTURES

SYMBOL/LINETYPE	ABV.	DESCRIPTION
[Symbol]	POLE	UTILITY POLE
[Symbol]	MH	MANHOLE
[Symbol]	HH	HAND HOLE
[Symbol]	PED	PEDESTAL
[Symbol]	F/H	FIRE HYDRANT
[Symbol]	VLV	VALVE
[Symbol]	TS	TRAFFIC SIGNAL
[Symbol]	SL	STREET LIGHT
[Symbol]	VNT	VENT
[Symbol]	MTR	WATER METER
[Symbol]	BOLL	BOLLARD
[Symbol]	TR	TREE

EXISTING UTILITIES

SYMBOL/LINETYPE	DESCRIPTION
[Symbol]	STREET LIGHT CONDUIT
[Symbol]	ELECTRIC
[Symbol]	TELEPHONE
[Symbol]	GAS
[Symbol]	STORM DRAIN
[Symbol]	SANITARY SEWER
[Symbol]	WATER
[Symbol]	CATV
[Symbol]	TRAFFIC CONDUIT
[Symbol]	COMM

MISC. LINETYPES

SYMBOL/LINETYPE	ABV.	DESCRIPTION
[Symbol]	C/L	CENTER LINE
[Symbol]	R/W	RIGHT OF WAY
[Symbol]	P/L	PROPERTY LINE
[Symbol]	EOP	EDGE OF PAVEMENT
[Symbol]	FOC	FRONT OF CURB
[Symbol]	C&G	CURB & GUTTER
[Symbol]	R/R	RAILROAD

MISC. ABBREVIATIONS

ABBREV.	DESCRIPTION
BCF	BEHIND CURB FACE
FCF	FRONT OF CURB FACE
CONC.	CONCRETE
EX	EXISTING
U/G	UNDERGROUND
S/W	SIDEWALK
D/W	DRIVEWAY
PL	PLACE (INSTALL NEW)

NOTICE TO CONTRACTORS

THE EXISTENCE AND LOCATION OF ALL UNDERGROUND UTILITIES SHOWN HERE WERE OBTAINED BY A SEARCH OF AVAILABLE RECORDS. CONTRACTOR IS REQUIRED TO LOCATE AND POT-HOLE ALL EXISTING UTILITY CROSSINGS PRIOR TO CONSTRUCTION.

DIGALERT
CALL TOLL FREE
48 HOURS BEFORE YOU DIG
UNDERGROUND SERVICE ALERT
PHONE NO. 811
IT'S THE LAW!

CONSTRUCTION PLAN

CLIENT LOGO	DRAWN	CB
	DESIGN	CB
	CHECKED	OSPRO
	DATE	2018
15 FWY CROSSING 15 FWY AND RANCHERO RD. HESPERIA, CA. 92345		3 OF 4
PROJECT #	TRACKING #	REV 0

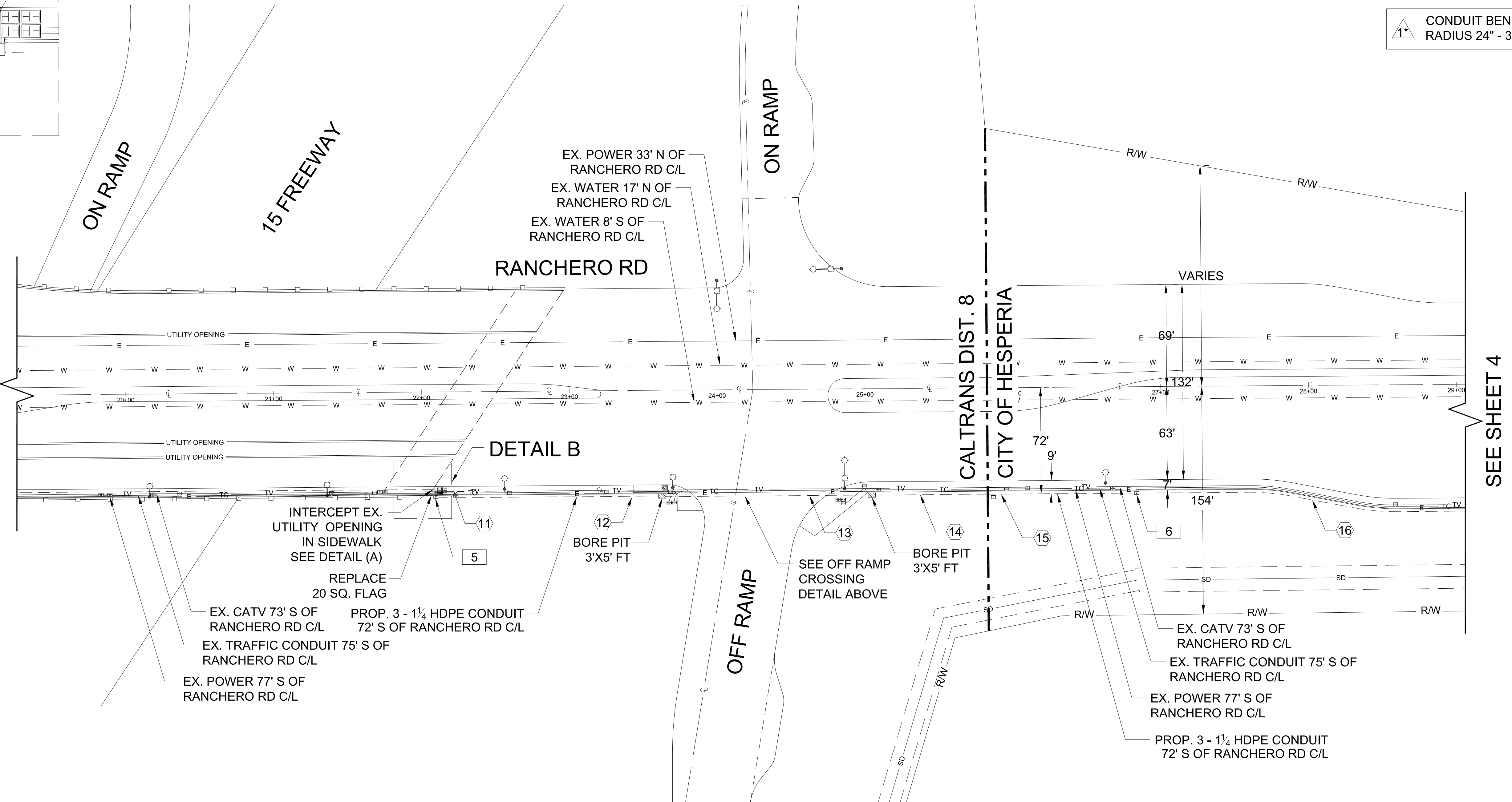

PROPOSED ITEM #	DESCRIPTION
17	156' VAULT 7 TO BORE PIT 3 - 12" HDPE CONDUIT
18	34' BORE PIT TO BORE PIT 3 - 12" HDPE CONDUIT
19	63' BORE PIT TO VAULT 8 3 - 12" HDPE CONDUIT
20	37' BORE PIT TO VAULT 8 3 - 12" HDPE CONDUIT
21	7' VAULT 8 TO EX. POLE# 4792610E 3 - 12" HDPE CONDUIT

PROPOSED VAULT LOCATION		
VAULT #	VAULT SIZE	LOCATION
7	2' X 3' VAULT	71' W OF MARIPOSA RD C/L @ STA 11+41
8	2' X 3' VAULT	58' S OF RANCHERO RD C/L @ STA 33+81

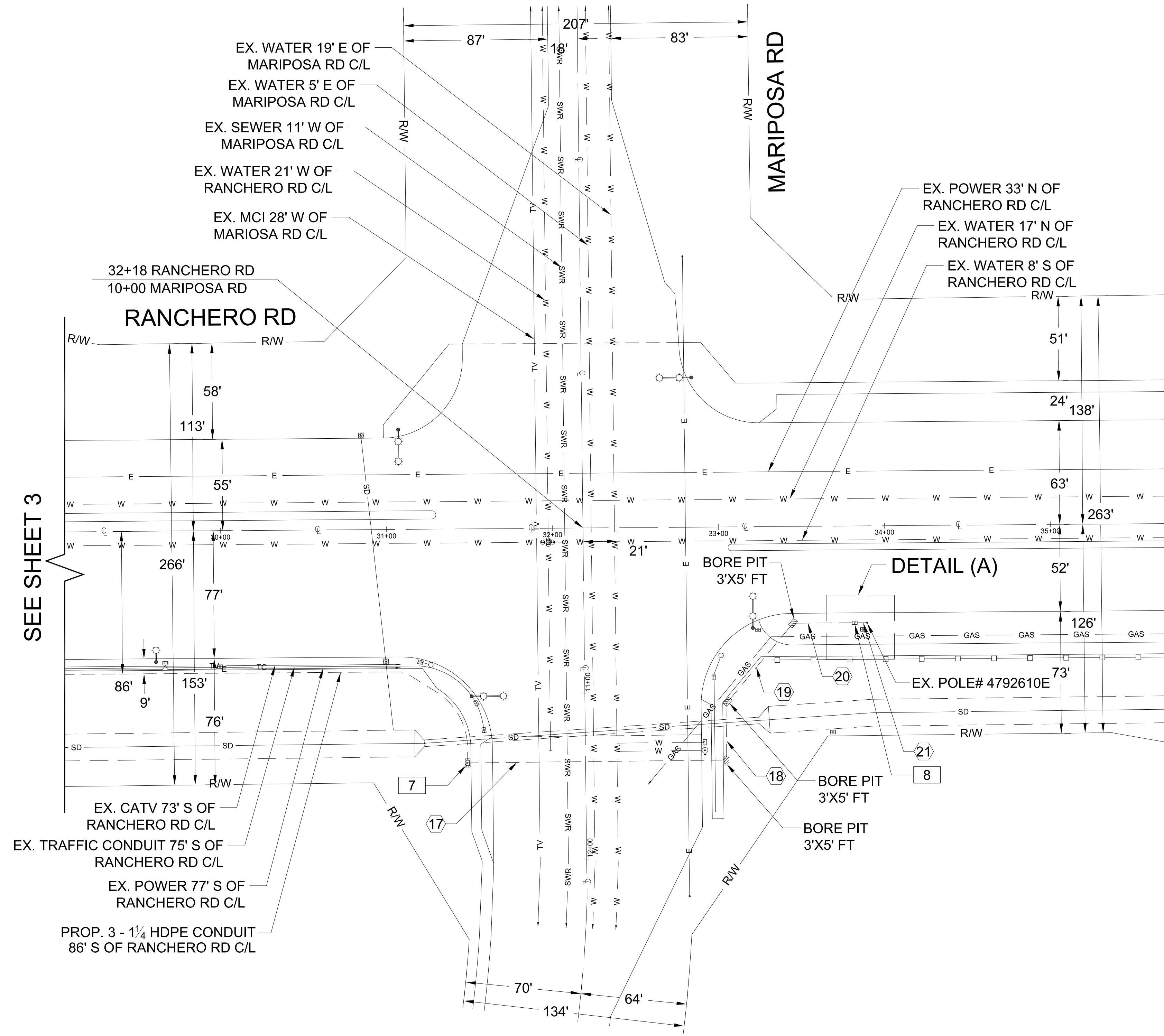

SEE SHEET 3

EX. POLE# 4792610E

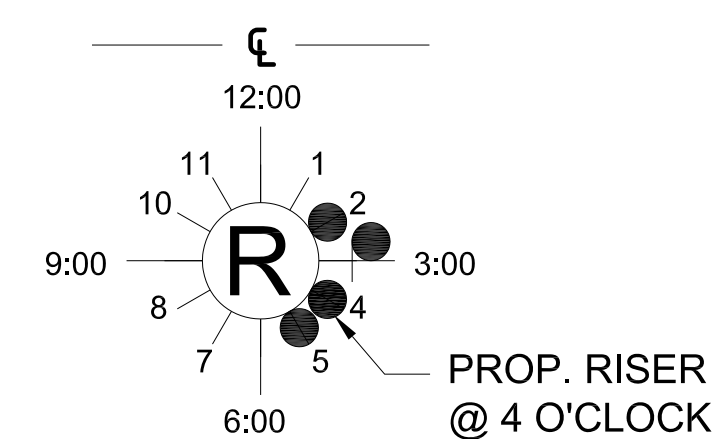

DETAIL (A)

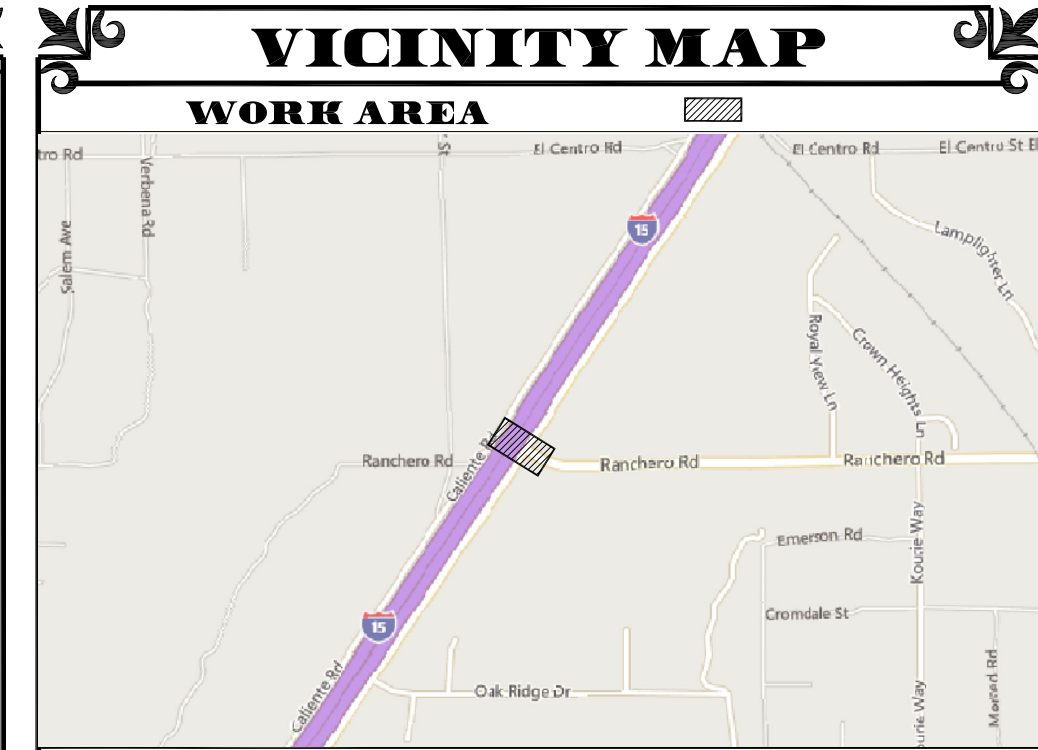
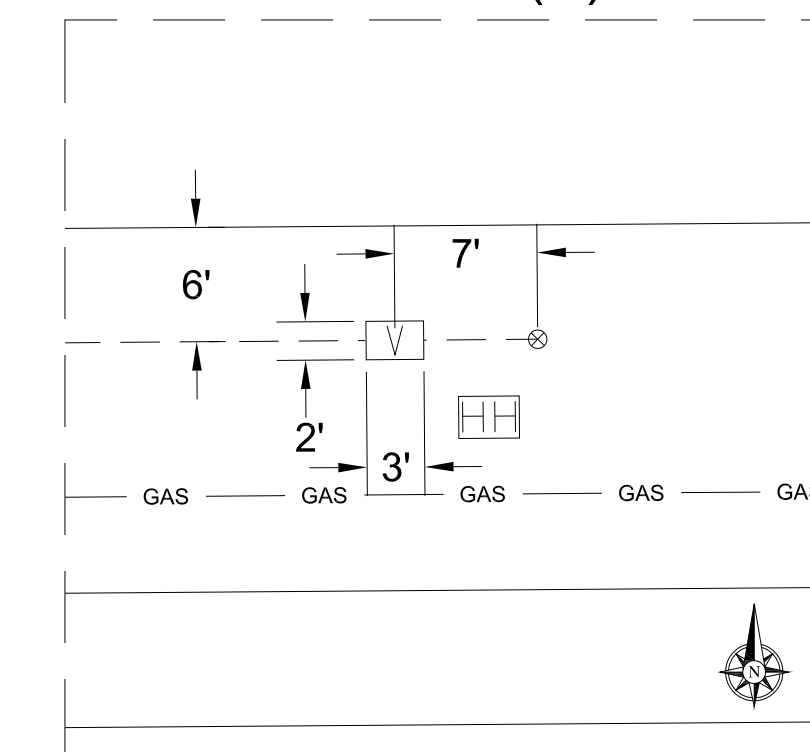

PREPARED BY:
O-S-Pro
 Telecom Solutions, LLC
 2001 THIRD ST #H, RIVERSIDE, CA 92507
 (626) 320-0996 | peterm@ospro.net

LEGEND	
PROPOSED WORK	
SYMBOL/LINETYPE	DESCRIPTION
[Symbol]	CONCRETE RESTORATION
[Symbol]	ASPHALT RESTORATION
[Symbol]	PROPOSED CONDUIT

EXISTING STRUCTURES		
SYMBOL/LINETYPE	ABV.	DESCRIPTION
[Symbol]	POLE	UTILITY POLE
[Symbol]	MH	MANHOLE
[Symbol]	HH	HAND HOLE
[Symbol]	PED	PEDESTAL
[Symbol]	F/H	FIRE HYDRANT
[Symbol]	VLV	VALVE
[Symbol]	TS	TRAFFIC SIGNAL
[Symbol]	SL	STREET LIGHT
[Symbol]	VNT	VENT
[Symbol]	MTR	WATER METER
[Symbol]	TR	BOLLARD
[Symbol]		TREE

EXISTING UTILITIES	
SYMBOL/LINETYPE	DESCRIPTION
[Symbol]	STREET LIGHT CONDUIT
[Symbol]	ELECTRIC
[Symbol]	TELEPHONE
[Symbol]	GAS
[Symbol]	STORM DRAIN
[Symbol]	SANITARY SEWER
[Symbol]	WATER
[Symbol]	CATV
[Symbol]	TRAFFIC CONDUIT
[Symbol]	COMM

MISC. LINETYPES		
SYMBOL/LINETYPE	ABV.	DESCRIPTION
[Symbol]	C/L	CENTER LINE
[Symbol]	R/W	RIGHT OF WAY
[Symbol]	P/L	PROPERTY LINE
[Symbol]	EOP	EDGE OF PAVEMENT
[Symbol]	FOC	FRONT OF CURB
[Symbol]	C&G	CURB & GUTTER
[Symbol]	R/R	RAILROAD

MISC. ABBREVIATIONS	
ABBV.	DESCRIPTION
BCF	BEHIND CURB FACE
FCF	FRONT OF CURB FACE
CONC.	CONCRETE
EX	EXISTING
U/G	UNDERGROUND
S/W	SIDEWALK
D/W	DRIVEWAY
PL	PLACE (INSTALL NEW)

NOTICE TO CONTRACTORS
 THE EXISTENCE AND LOCATION OF ALL UNDERGROUND UTILITIES SHOWN HERE WERE OBTAINED BY A SEARCH OF AVAILABLE RECORDS. CONTRACTOR IS REQUIRED TO LOCATE AND POT HOLE ALL EXISTING UTILITY CROSSINGS PRIOR TO CONSTRUCTION.

DIGALERT
 CALL TOLL FREE
 48 HOURS BEFORE YOU DIG
 UNDERGROUND SERVICE ALERT
 PHONE NO. 811
 IT'S THE LAW!

CONSTRUCTION PLAN	
CLIENT LOGO	
15 FWY CROSSING 15 FWY AND RANCHERO RD. HESPERIA, CA. 92345	DRAWN CB DESIGN CB CHECKED OSPRO DATE 2018
	4 OF 4

PROJECT # _____ TRACKING # _____ REV 0